



pearson  
ferrier®



99 STONEMERE DRIVE  
Manchester, M26 1QY  
No Offers £125,000



# 99 STONEMERE DRIVE

## Property at a glance

- top floor apartment
- two bedrooms
- PVC double glazing & electric heating
- spacious lounge with double opening PVC patio doors with Juliet balcony
- separate modern fitted kitchen with integrated appliances
- modern bathroom inc shower over bath
- allocated off road parking & communal gardens
- viewing a must!!

\*\*\*REDUCED\*\*\*REDUCED\*\*\*REDUCED\*\*\*REDUCED\*\*\*REC

A modern built two bedroom top floor apartment which boasts proximity to local amenities, including schools, shops, and the vibrant nightlife of Whitefield with its array of bars and restaurants. Commuters will appreciate the easy access to Whitefield Met Station and nearby motorway networks, facilitating seamless travel to Manchester City Centre and beyond. Ideal for first-time buyers embarking on their property journey or Buy to Let property investors expanding their portfolio, this home beckons with its inviting features. Enjoy the warmth of the cosy lounge, the functionality of the modern fitted kitchen with integrated appliances. Rest peacefully in two bedrooms, a modern family bathroom completes the living space. Outside, communal gardens and allocated parking. Additional features include PVC double glazing and electric heating. With its desirable location and array of features, early viewing is highly recommended to fully appreciate the this property.







GROUND FLOOR  
575 sq.ft. (53.4 sq.m.) approx.

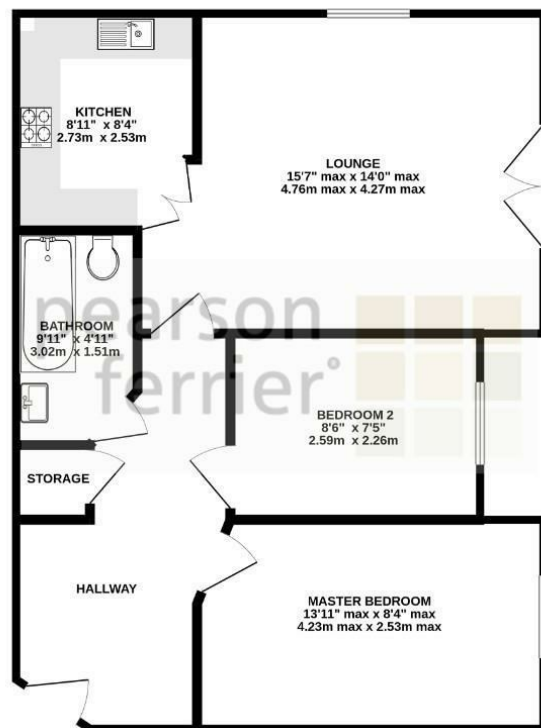

TOTAL FLOOR AREA: 575 sq ft. (53.4 sq.m.) approx.  
While every attempt has been made to ensure the accuracy of the floorplan contained here, measurements of doors, windows, rooms and any other items are approximate and no responsibility is taken for any error, omissions or misstatements. This plan is for illustrative purposes only and should be used as such by any prospective purchaser. The services, systems and appliances shown have not been tested and no guarantee as to their operability or efficiency can be given.  
Made with Metropac i2025.

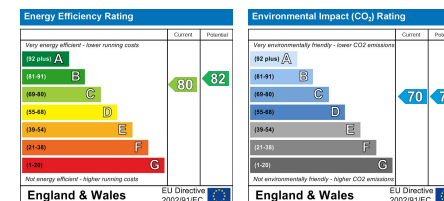

Radcliffe Office

44 Blackburn Street Radcliffe, Manchester, M26 1NQ

Telephone: 0161 725 8155

Fax: #

Email: radcliffe@pearsonferrier.co.uk

[www.pearsonferrier.co.uk](http://www.pearsonferrier.co.uk)



All statements contained in these particulars are for indicative purposes only and are made without responsibility on the part of Pearson Ferrier and the vendors of this property and are not to be relied on as statements or representations of fact. Potential purchasers should satisfy themselves by inspection or otherwise as to the accuracy of such details contained in these particulars.